

TRAFFIC SWINGING SINGLE LEAF DOORS

ALL PRICES IN US DOLLARS, DO NOT INCLUDE VAT. 2 MM THICK METAL DOOR FRAME INCLUDED

(TSD)

30.10.2023

- PH Insulation's traffic swinging doors are designed to separate production and other premises in places with intensive traffic of personnel.
- The factory-made doors are ready for installation on technological, industrial premises, supermarkets, hospitals, food production facilities, cafes, restaurants, etc.
- Traffic doors are not meant to completely seal the opening due to technical clearance gaps along the perimeter between the frame and the door leaf.
- If you need the doors to remain open in 90-degree position, you can order traffic doors with fixating hinges. Doors can be equipped with oval windows of 200x500 or 300x580 mm.
- Traffic doors are available in custom sizes and are equipped with the European-made hardware: Italian, Spanish, – according to customer's request.

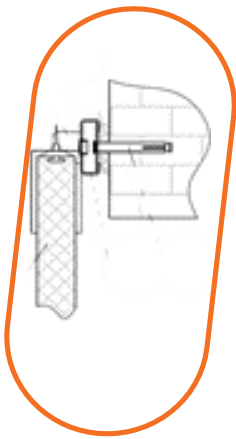

OVERHEAD FRAME

INSTALLATION OPENING, HEIGHT, MM	INSTALLATION OPENING, WIDTH, MM						
	700	800	900	1000	1100	1200	1300
1800	331	365	372	382	389	404	479
1900	335	371	377	388	395	474	486
2000	339	376	383	394	402	480	493
2100	343	382	389	401	470	487	500
2200	349	389	397	409	478	496	510
2300	355	398	406	480	488	507	586
2400	359	404	412	486	495	514	593
2500	436	485	494	508	518	537	620
2600	441	491	501	515	525	611	628
2700	446	498	508	523	533	620	636
2800	452	506	516	531	606	629	646
2900	519	575	586	603	613	637	654
3000	524	582	593	610	621	645	663
3100	528	588	599	616	628	652	670
3200	533	595	606	624	635	660	678
3300	540	604	616	634	645	670	689

RAL 9003

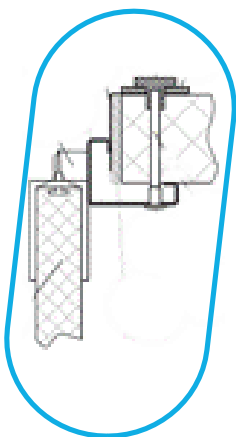

ANGULAR FRAME

INSTALLATION OPENING, HEIGHT, MM	INSTALLATION OPENING, WIDTH, MM						
	700	800	900	1000	1100	1200	1300
1800	354	389	396	408	416	432	510
1900	359	395	403	415	423	504	517
2000	363	402	409	422	430	511	525
2100	368	408	416	428	500	519	533
2200	372	414	422	435	507	526	540
2300	381	425	434	510	519	539	621
2400	386	432	441	517	527	547	629
2500	464	514	524	540	550	571	656
2600	471	523	533	549	559	649	666
2700	479	533	543	559	570	660	679
2800	485	541	551	568	645	669	688
2900	554	612	624	642	653	678	697
3000	558	618	630	648	660	685	704
3100	563	625	637	656	668	694	713
3200	571	635	648	666	679	705	725
3300	580	646	658	678	690	717	737

RAL 9003





OVERLAPPING FRAME

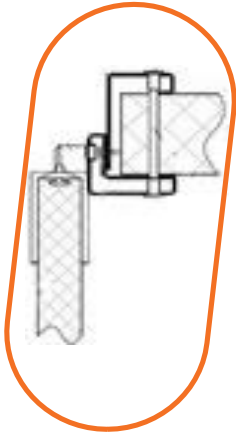

INSTALLATION OPENING, HEIGHT, MM	INSTALLATION OPENING, WIDTH, MM						
	700	800	900	1000	1100	1200	1300
1800	420	458	467	482	491	511	594
1900	427	467	476	491	501	588	605
2000	438	480	490	505	515	604	621
2100	444	489	499	514	591	614	631
2200	452	497	508	524	600	624	642
2300	463	511	522	604	616	640	728
2400	471	521	532	615	627	651	740
2500	558	613	625	644	657	683	776
2600	568	625	637	656	669	768	789
2700	576	635	648	667	681	779	801
2800	585	646	659	679	762	792	814
2900	660	723	737	759	774	804	827
3000	663	728	743	765	779	810	833
3100	671	738	753	776	791	822	845
3200	685	755	770	793	808	840	864
3300	694	766	781	804	820	852	876

RAL 9003

OUR DOORS ARE AVAILABLE IN CUSTOM SIZES TO INSURE BEST COMMERCIAL APPLICATION

TRAFFIC SWINGING DOUBLE LEAF DOORS

ALL PRICES IN US DOLLARS, DO NOT INCLUDE VAT. 2 MM THICK METAL DOOR FRAME INCLUDED

(TOD)

30.10.2023

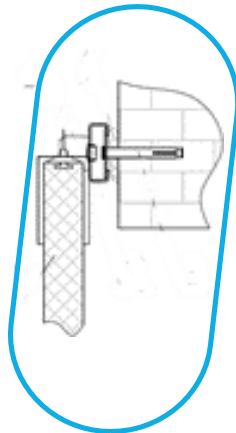

OVERHEAD FRAME

INSTALLATION OPENING, HEIGHT, MM	INSTALLATION OPENING, WIDTH, MM				
	1000	1100	1200	1300	1400
1800	614	617	624	627	689
1900	621	624	631	635	700
2000	628	632	639	643	712
2100	635	639	647	650	723
2200	643	647	655	658	734
2300	656	660	668	672	752
2400	671	675	683	687	772
2500	819	824	832	837	926
2600	833	838	847	851	944
2700				861	958
2800				873	973
2900				1016	1119
3000				1026	1133
3100				1035	1146
3200				1045	1159
3300				1059	1177

RAL 9003

OVERHEAD FRAME

INSTALLATION OPENING, HEIGHT, MM	INSTALLATION OPENING, WIDTH, MM				
	1500	1600	1700	1800	1900

RAL 9003	1800	693	696	699	702	705
	1900	703	707	710	713	716
	2000	715	719	722	725	729
	2100	726	730	733	737	740
	2200	738	741	745	749	753
	2300	756	760	764	768	900
	2400	776	780	784	788	922
	2500	930	934	939	943	947
	2600	948	953	957	962	966
	2700	962	967	972	976	981
	2800	978	983	988	992	997
	2900	1124	1129	1134	1139	1144
	3000	1138	1143	1148	1153	1158
	3100	1151	1156	1161	1167	1172
	3200	1165	1170	1176	1181	1186
	3300	1182	1188	1193	1199	1204

OVERHEAD FRAME

RAL 9003	INSTALLATION OPENING, HEIGHT, MM	INSTALLATION OPENING, WIDTH, MM						
		2 000	2 100	2 200	2 300	2 400	2 500	2 600
	1800	708	732	736	739	742	876	880
	1900	720	745	748	882	885	889	893
	2000	732	758	761	896	899	903	907
	2100	744	901	904	908	912	915	920
	2200	756	914	918	921	925	929	934
	2300	904	935	939	943	947	1084	1089
	2400	926	958	962	966	971	1109	1114
	2500	952	985	989	993	998	1138	1144
	2600	970	1004	1009	1149	1154	1158	1164
	2700	985	1020	1024	1165	1169	1174	1180
	2800	1002	1173	1178	1183	1187	1192	1198
	2900	1148	1188	1193	1198	1203	1208	1215
	3000	1163	1203	1209	1214	1219	1224	1231
	3100	1177	1218	1223	1228	1234	1239	1246
	3200	1192	1233	1238	1244	1249	1255	1262
	3300	1210	1252	1257	1263	1269	1275	1281

ANGULAR FRAME

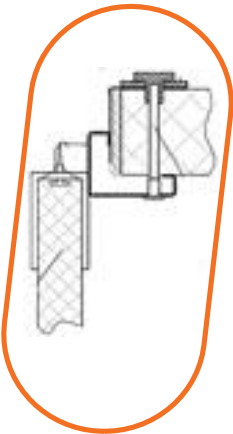

RAL 9003	INSTALLATION OPENING, HEIGHT, MM	INSTALLATION OPENING, WIDTH, MM				
		1000	1100	1200	1300	1400
	1800	635	638	646	649	712
	1900	643	647	654	658	724
	2000	651	655	663	667	737
	2100	660	663	672	675	749
	2200	668	672	680	684	761
	2300	682	686	695	699	780
	2400	697	702	711	715	801
	2500	847	852	861	866	956
	2600	861	866	875	880	974
	2700				891	988
	2800				902	1003
	2900				1046	1150
	3000				1055	1163
	3100				1066	1177
	3200				1079	1194
	3300				1090	1209

ANGULAR FRAME

RAL 9003	INSTALLATION OPENING, HEIGHT, MM	INSTALLATION OPENING, WIDTH, MM				
		1500	1600	1700	1800	1900
	1800	716	719	723	726	729
	1900	728	732	735	739	742
	2000	740	744	748	752	755

RAL 9003	2 100	753	757	761	764	768
	2 200	765	769	773	777	781
	2 300	785	789	793	797	932
	2 400	805	810	814	818	954
	2 500	960	965	969	974	979
	2 600	979	983	988	993	998
	2 700	993	998	1 003	1 008	1 013
	2 800	1 008	1 013	1 018	1 023	1 028
	2 900	1 155	1 161	1 166	1 171	1 176
	3 000	1 168	1 173	1 179	1 184	1 190
	3 100	1 183	1 188	1 194	1 199	1 205
	3 200	1 200	1 205	1 211	1 217	1 223
	3 300	1 214	1 220	1 226	1 232	1 238

ANGULAR FRAME

RAL 9003	INSTALLATION OPENING, HEIGHT, MM	INSTALLATION OPENING, WIDTH, MM					
		2 000	2 100	2 200	2 300	2 400	2 500
1 800	733	758	762	765	769	905	910
1 900	746	772	776	912	915	919	925
2 000	759	786	790	926	930	933	939
2 100	772	932	936	940	944	948	954
2 200	785	946	950	954	958	962	969
2 300	936	968	973	977	981	1 119	1 126
2 400	959	992	996	1 001	1 006	1 145	1 152
2 500	983	1 018	1 022	1 027	1 032	1 173	1 180
2 600	1 002	1 037	1 042	1 184	1 189	1 194	1 201
2 700	1 018	1 054	1 059	1 200	1 205	1 210	1 218
2 800	1 033	1 206	1 212	1 217	1 222	1 227	1 235
2 900	1 182	1 222	1 228	1 233	1 239	1 244	1 252
3 000	1 195	1 236	1 242	1 248	1 253	1 259	1 266
3 100	1 210	1 253	1 258	1 264	1 270	1 275	1 283
3 200	1 228	1 271	1 277	1 283	1 289	1 294	1 302
3 300	1 244	1 287	1 293	1 299	1 305	1 311	1 319

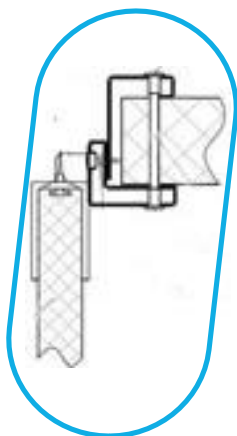

OVERLAPPING FRAME

RAL 9003	INSTALLATION OPENING, HEIGHT, MM	INSTALLATION OPENING, WIDTH, MM			
		1 000	1 100	1 200	1 300
1 800	713	717	726	731	797
1 900	725	730	739	744	814
2 000	735	740	749	754	828
2 100	748	753	763	768	845
2 200	758	764	773	779	860
2 300	777	783	793	798	884
2 400	798	804	814	820	910
2 500	955	961	971	977	1 071
2 600	971	977	987	994	1 091
2 700				1 008	1 109
2 800				1 022	1 126
2 900				1 172	1 280
3 000				1 180	1 292
3 100				1 194	1 310
3 200				1 214	1 333
3 300				1 228	1 351

OVERLAPPING FRAME

RAL 9003	INSTALLATION OPENING, HEIGHT, MM	INSTALLATION OPENING, WIDTH, MM			
		1 500	1 600	1 700	1 800
1 800	802	807	811	816	821
1 900	818	823	828	833	838
2 000	833	838	843	848	853
2 100	850	856	861	866	871
2 200	865	870	876	881	886
2 300	889	895	900	906	1 046

RAL 9003	2 400	916	921	927	933	1 075
	2 500	1 077	1 083	1 089	1 095	1 101
	2 600	1 097	1 103	1 109	1 115	1 122
	2 700	1 115	1 121	1 127	1 134	1 140
	2 800	1 133	1 139	1 146	1 152	1 158
	2 900	1 287	1 293	1 300	1 307	1 313
	3 000	1 299	1 306	1 313	1 319	1 326
	3 100	1 317	1 324	1 330	1 337	1 344
	3 200	1 340	1 347	1 354	1 362	1 369
	3 300	1 358	1 365	1 373	1 380	1 387

OVERLAPPING FRAME

	INSTALLATION OPENING, HEIGHT, MM	INSTALLATION OPENING, WIDTH, MM						
		2 000	2 100	2 200	2 300	2 400	2 500	2 600
RAL 9003	1 800	826	855	860	865	870	1 011	1 021
	1 900	843	874	879	1 020	1 025	1 030	1 041
	2 000	858	889	895	1 036	1 041	1 047	1 057
	2 100	877	1 045	1 050	1 056	1 061	1 067	1 078
	2 200	892	1 061	1 066	1 072	1 078	1 083	1 094
	2 300	1 051	1 089	1 094	1 100	1 106	1 250	1 261
	2 400	1 081	1 119	1 125	1 131	1 137	1 283	1 295
	2 500	1 107	1 147	1 153	1 159	1 165	1 311	1 323
	2 600	1 128	1 168	1 174	1 321	1 327	1 333	1 345
	2 700	1 147	1 187	1 194	1 340	1 347	1 353	1 365
	2 800	1 165	1 347	1 353	1 360	1 367	1 373	1 386
	2 900	1 320	1 366	1 373	1 380	1 387	1 394	1 406
	3 000	1 333	1 380	1 387	1 394	1 401	1 408	1 421
	3 100	1 351	1 399	1 406	1 413	1 420	1 428	1 441
	3 200	1 376	1 424	1 432	1 439	1 446	1 454	1 467
	3 300	1 395	1 444	1 451	1 459	1 466	1 474	1 487

OUR DOORS ARE AVAILABLE IN CUSTOM SIZES TO INSURE BEST COMMERCIAL APPLICATION

DOOR CATALOGUE CODES

TSD	SWINGING SINGLE LEAF DOORS
TDD	SWINGING DOUBLE LEAF DOORS
RIGHT / LEFT	HINGES ON THE RIGHT / HINGES ON THE LEFT

EXAMPLE OF DOOR CATALOGUE CODE: TSD 800 2000 40 RAL9003/RAL9003 ANG RIGHT

DOOR TYPE	DOORWAY WIDTH	DOORWAY HEIGHT	DOOR THICKNESS	COVERING MATERIAL		FRAME TYPE	HINGES LOCATION
				EXTERIOR METAL	INTERIOR METAL		
TSD	800	2 000	40	RAL9003	RAL9003	ANGULAR	RIGHT

ADDITIONAL OPTIONS FOR TRAFFIC SWINGING DOORS

ITEM	PRICE
TDD FRAME INSTALLATION HARDWARE TO INSULATED SANDWICH PANELS	13
TSD FRAME INSTALLATION HARDWARE TO INSULATED SANDWICH	9
TDD FRAME INSTALLATION HARDWARE TO A BRICK WALL	8
TSD FRAME INSTALLATION HARDWARE TO A BRICK WALL	4
FRAME INSTALLATION HARDWARE FOR STEEL STUD CONSTRUCTION	2
DOOR BLADE MATERIAL: AISI 304, PRICE FOR 1 SQ. M	33
DOOR BLADE MATERIAL: AISI 430, PRICE FOR 1 SQ. M	23
OVERHEAD FRAME AISI 304, PRICE FOR RUNNING METER	18
ANGULAR FRAME AISI 304, PRICE FOR RUNNING METER	31

OVERLAPPING FRAME AISI 304, PRICE FOR RUNNING METER	82
OVERHEAD FRAME AISI 430, PRICE FOR RUNNING METER	11
ANGULAR FRAME AISI 430, PRICE FOR RUNNING METER	18
OVERLAPPING FRAME AISI 430, PRICE FOR RUNNING METER	47
HIDDEN INSTALLATION HARDWARE FOR TSD	45
HIDDEN INSTALLATION HARDWARE FOR TDD	53
HIDDEN INSTALLATION HARDWARE FOR TSD WITH AISI 304 FRAME	62
HIDDEN INSTALLATION HARDWARE FOR TDD WITH AISI 304 FRAME	55
HIDDEN INSTALLATION HARDWARE FOR TSD WITH AISI 430 FRAME	73
HIDDEN INSTALLATION HARDWARE FOR TDD WITH AISI 304 FRAME	65

FACTORY INSTALLED BUMPERS FOR TSD

BUMPER MATERIAL	THICKNESS, MM	PRICE FOR SQ. M	PRICE FOR RUNNING METER	
			BOTTOM 0,25 M	BOTTOM 0,5 M
AISI 304	1,5	110	27	55
AISI 430	1,5	73	18	36
ALUMINIUM CHECKER PLATE	1,5	58	14	29
FLAT HDP PLASTIC	4,0	33	8	16
CURVED HDP PLASTIC	6,0	47	12	24

FACTORY INSTALLED BUMPERS FOR TDD

BUMPER MATERIAL	THICKNESS, MM	PRICE FOR SQ. M	PRICE FOR RUNNING METER	
			BOTTOM 0,25 M	BOTTOM 0,5 M
AISI 304	1,5	115	29	58
AISI 430	1,5	76	19	38
ALUMINIUM CHECKER PLATE	1,5	61	15	31
FLAT HDP PLASTIC	4,0	34	8	17
CURVED HDP PLASTIC	4,0	39	10	19
CURVED HDP PLASTIC	6,0	48	12	24

PACKAGING

ITEM	PRICE
STRETCH-WRAP	INCLUDED IN DOOR PRICE
CARDBOARD PACKAGING	CALCULATED INDIVIDUALLY FOR YOUR ORDER
WOODEN PACKAGING	CALCULATED INDIVIDUALLY FOR YOUR ORDER



+7 (495) 745-01-37

WWW.PROFHOLOD.COM